

A full range of **quality** mains rated **inlets, outlets** and **connectors** conforming to **IEC** and EN 60320 specifications carrying **UL** as well as **cUL, VDE** and other approvals.

With electrical ratings up to 20A, 250V (UL) these connector ranges offer solutions to most mains powered equipment and cable applications.

The combinations of mounting styles and terminations include: flange fixing, snap to panel and PCB mounting versions together with 2.8/ solder tabs, 4.8 and 6.3 fast on tabs, screw terminal and PC spill versions.

Completing the range are insulating boots, retaining and safety covers

In addition to the standard black moulding, most styles are also available in either white or grey and special colours to match OEM equipment can also be supplied. (Subject to product approval requirements)

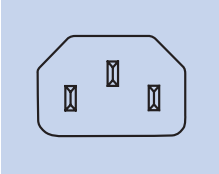
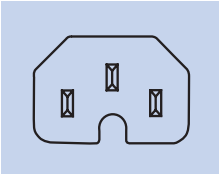
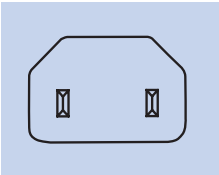
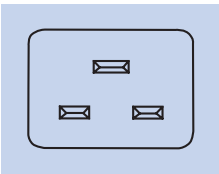

| | |
|----------------------------------|-----|
| IEC60320 Main Inlets and Outlets | 2 |
| IEC Distribution Units | 470 |
| Power Entry Modules | 475 |
| Mains Filters | 497 |

| IEC 60320-1 | Sheet No: | No Plugs | Current Rating | Flange Fixing | Snap fit | Fused Flange | Fused Snap fit | Filtered | Fuse Filtered |
|-----------------------------------------------------------------------------------|-----------|----------|----------------|----------------------------------------------------------------------------------|---------------------|------------------------------------------------------|---------------------|--------------|------------------------------|
|  | C14 | 3 | 10A, 250V AC | PX0579 PX0580 PX0580/PC PX0580/PC/12132 PX0580/PC/7 PX0580/PC/7LC | PX0575 PX0575/PC | PF0001 PF0001/PC PF0002 PF0030 PF0030/PC | PF0011 PF0011/PC | PS00 PS01 | PS20 PS21 PS25 PS26 |
|  | C16 | 3 | 10A, 250V AC | PX0590 | PX0595 | | | | |
|  | C18 | 2 | 10A, 250V AC | PX0690 | PX0691 PX0691/PC | PF0006 PF0007 | PF0016 | | |
|  | C20 | 3 | 3 16A, 250V AC | PX0596 | PX0598 | | | | |

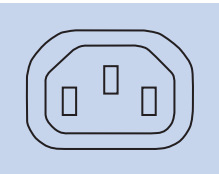
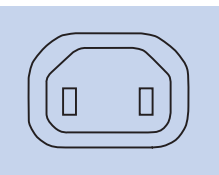
| IEC 60320-2-2 | Sheet No: | No Plugs | Current Rating | Flange Fixing | Snap fit | Fused Flange | Fused Snap fit | Filtered | Fuse Filtered |
|------------------------------------------------------------------------------------|-----------|----------|----------------|-------------------------------------------------------------------------------------|--------------------------------------------------------|--------------|----------------|----------|---------------|
|  | F | 3 | 10A, 250V AC | PX0675 PX0675/PC PX0675/PC/12599 PX0793 (Shuttered) PX0793/1(Shuttered) | PX0695 PX0695/PC PX0783 (Shuttered) PX0716 | | | | |
|  | H | 2 | 10A, 250V AC | PX0705 | PX0725 | | | | |

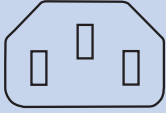
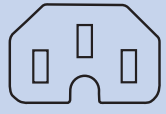
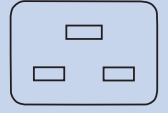
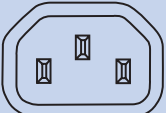
| IEC 60320-1 | Sheet No: | No Plugs | Current Rating | Rewirable | Side Entry Rewirable |
|-------------------------------------------------------------------------------------|-----------|----------|----------------|------------------|----------------------|
|  | C13 | 3 | 10A, 250V AC | PX0587 PX0588 | PX0587/SE |
|  | C15 | 3 | 10A, 250V AC | PX0597 | |
|  | C19 | 3 | 16A, 250V AC | PX0599 | |
| IEC 60320-2-2 | Sheet No: | No Plugs | Current Rating | Rewirable | Side Entry Rewirable |
|  | E | 3 | 10A, 250V AC | PX0686 | PX0685 PX0686/SE |

Straight Female Connector



PX0587

- Cable Mounting
- Rewirable
- Screw Terminals
- 10A, 250V AC

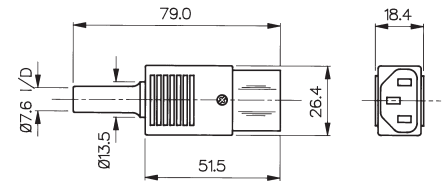

Side Entry Female Connector



PX0587/SE

- Cable Mounting
- Rewirable
- Screw Terminals
- 10A, 250V AC

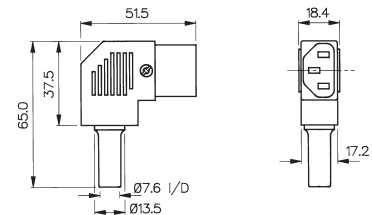



Right Angle Female Connector

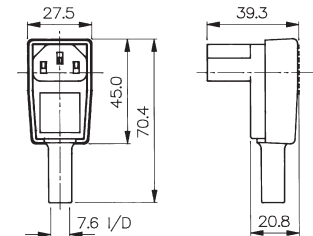

PX0588

- Cable Mounting
- Rewirable
- Screw Terminals
- 10A, 250V AC

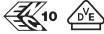
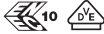

| Specifications | PX0587/Col | PX0587/SE/Col | PX0588 |
|------------------------|-------------------------------------------------------------------------------------|-------------------------------------------------------------------------------------|---------------------------------------------------------------------------------------|
| Terminations: | Screw Terminals | Screw Terminals | Screw Terminals |
| Colours: | No suffix (Black), /WH (White), /GY (Grey) | No suffix (Black), /WH (White), /GY (Grey) | - |
| Max. Rating: | 10A, 250V AC | 10A, 250V AC | 10A, 250V AC |
| Contact Resistance: | <10mΩ | <10mΩ | <10mΩ |
| Insulation Resistance: | >10 ³ MΩ | >10 ³ MΩ | >10 ³ MΩ |
| A.C. Breakdown: | Contact-Contact 4.5kV. (Contacts-Accessible) Parts 4kV | Contact-Contact 4.5kV. (Contacts-Accessible) Parts 4kV | Contact-Contact 5kV. (Contacts-Accessible) Parts 3.5kV |
| Operating Temp. | -40°C to +70°C | -40°C to +70°C | -40°C to +70°C |
| Withdrawal Force: | 10N (Min.) 50N (Max.) | 10N (Min.) 50N (Max.) | 10N (Min.) 50N (Max.) |
| Mouldings: | Nylon, Flammability Rating UL94V-0 | Nylon, Flammability Rating UL94V-0 | Nylon, Flammability Rating UL94V-0 |
| Contacts: | Brass, Clean | Brass, Clean | Brass, Clean |
| Approvals: |  |  |  |
| Accessories / Notes: | VDE and ENEC approval for black and white versions only. | VDE and ENEC approval for black and white versions only. | |
| Mating Inlets: | PX0575, PX0579, PX0580, PF0001, PF0011, PF0030, PF0033 | PX0575, PX0579, PX0580, PF0001, PF0011, PF0030, PF0033 | PX0575, PX0579, PX0580, PF0001, PF0011, PF0030, PF0033 |
| RoHS | Compliant | Compliant | Compliant |

Snap Fit to Panel Inlet



PX0575/10/28

- Fits Panel Thickness 1, 1.5, 2.0 or 3.0mm
- 2.8, 4.8, 6.3mm Tabs or Screw Terminals
- 10A, 250V AC (15A, 250V AC cULus)

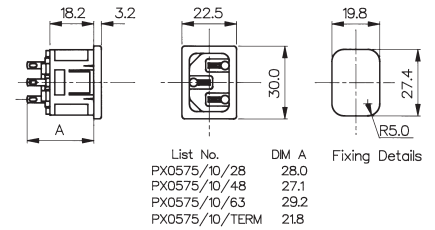



PC Snap Fit to Panel Inlet

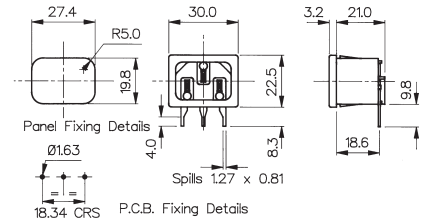

PX0575/10/PC

- Fits Panel Thickness 1, 1.5, 2.0 or 3.0mm
- PC Spills
- 10A, 250V AC (15A, 250V AC cULus)



| Specifications | PX0575/Fixing/Termination/Colour | PX0575/Fixing/PC/Colour |
|--------------------------|-------------------------------------------------------------------------------------|--------------------------------------------------------------------------------------------------------------------------------------|
| FIXING(Panel Thickness): | Snap fit, /10 (1mm), /15 (1.5mm), /20 (2mm), /30 (3mm) | Snap fit, /10 (1mm), /15 (1.5mm), /20 (2mm), /30 (3mm) |
| TERMINATIONS: | /28 (2.8mm solder), /48 (4.8mm tab) | P.C. Spills |
| COLOURS: | No suffix (Black), /WH (White), /GY (Grey) | No suffix (Black), /WH (White), /GY (Grey) |
| Max. Rating: | 10A, 250V AC (cULus 15A, 250V AC) | 10A, 250V AC (cULus 15A, 250V AC) |
| Contact Resistance: | <10mΩ | <10mΩ |
| Insulation Resistance: | >10 ³ MΩ | >10 ³ MΩ |
| A.C. Breakdown: | Contact-Contact 5kV. Contacts-Panel 5.4kV | Contact-Contact 5kV. Contacts-Panel 5.4kV |
| Operating Temp. Range: | -40°C to +70°C | -40°C to +70°C |
| Max. Plug Temp.: | +70°C | +70°C |
| Mouldings: | Nylon, Flammability Rating UL94V-0 | Nylon, Flammability Rating UL94V-0 |
| Contacts: | Brass: Plugs, Nickel Plated. Tabs, Tin Plated, Screw Terms, Nickel Plated | Brass: Plugs, Nickel Plated. Spills, Tin Plated |
| Approvals: |  |  |
| Accessories / Notes: | P.No. 11328 (See Page 23) VDE and ENEC approval for black versions only. | Standard without cover. With cover add /C to P.No. PX0587, PX0587/SE, PX0588 VDE and ENEC approval for black versions only. |
| Mating Connectors: | PX0587, PX0587/SE, PX0588 | PX0587, PX0587/SE, PX0588 |
| RoHS | Compliant | Compliant |

Flange Mount Inlet



PX0580/28

- 2.8, 4.8, 6.3mm Tabs or Screw Terminals
- 10A, 250V AC (15A, 250V AC UL & CSA)

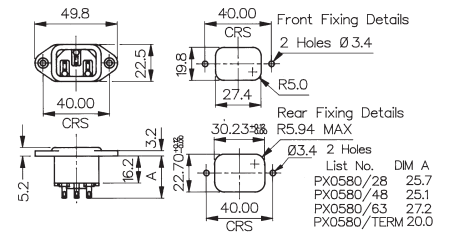

Vertical Flange Mount Inlet



PX0579/28

- 2.8, 4.8, 6.3mm Tabs or Screw Terminals
- 10A, 250V AC (15A, 250V AC UL & CSA)

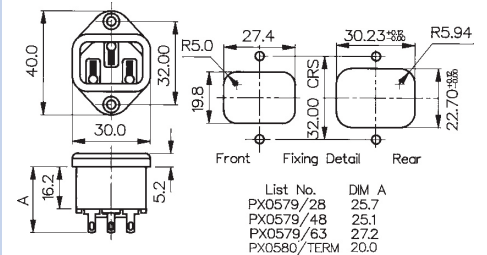

| Specifications | PX0580/Termination/Colour | PX0579/Termination/Colour |
|--------------------------|--------------------------------------------------------------------------------------------------------------|---------------------------------------------------------------------------------------|
| FIXING: | Flange | Flange |
| TERMINATIONS: | /28 (2.8mm solder), /48 (4.8mm tab) /63 (6.3mm tab), /TERM (screw) | /28 (2.8mm solder), /48 (4.8mm tab) /63 (6.3mm tab) |
| COLOURS: Max. Rating: | No suffix (Black), /WH (White), /GY (Grey) 10A, 250V AC (UL & CSA 15A, 250V AC) | No suffix (Black), /WH (White), /GY (Grey) 10A, 250V AC (UL & CSA 15A, 250V AC) |
| Contact Resistance: | <10mΩ | <10mΩ |
| Insulation Resistance: | >10 ³ MΩ | >10 ³ MΩ |
| A.C. Breakdown: | Contact-Contact 5kV. Contacts-Panel 10kV | Contact-Contact 5kV. Contacts-Panel 10kV |
| Operating Temp. | -40°C to +70°C | -40°C to +70°C |
| Max. Plug Temp.: | +70°C | +70°C |
| Mouldings: | Nylon, Flammability Rating UL94V-0 | Nylon, Flammability Rating UL94V-0 |
| Contacts: | Brass: Plugs, Nickel Plated. Tabs, Tin Plated, Screw Terms, Nickel Plated | Brass: Plugs, Nickel Plated. Tabs, Tin Plated |
| Approvals: |  |  |
| Accessories / Notes: | P.No. 11328, KT0006 (PX0587 only) (See Pages 21 and 23) VDE and ENEC approval for black versions only. | P.No. 11328 (See Page 23) |
| Mating Connectors: | PX0587, PX0587/SE, PX0588 | PX0587, PX0587/SE, PX0588 |
| RoHS | Compliant | Compliant |

PC Flange Rear Mount Inlet



PX0580/PC

- Supplied Rear Cover
- PC Spills
- 10A, 250V AC
(15A, 250V AC UL & CSA)

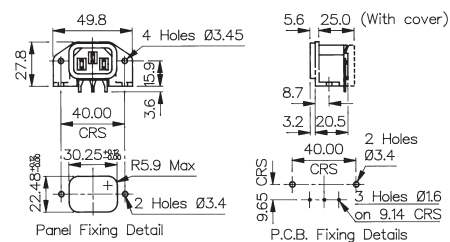

PC Flange Rear Mount Inlet



PX0580/PC/7

- Supplied Rear Cover
- PC Spills
- 4.8mm Top Tab (earth)
- 10A, 250V AC
(15A, 250V AC UL & CSA)

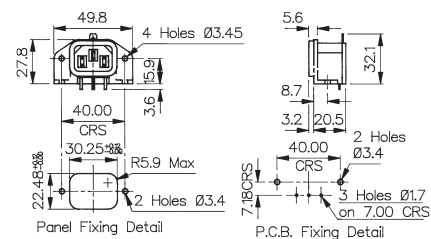

Specifications

PX0580/PC/Colour

PX0580/PC/7/Colour

FIXING:

P.C.B./Flange

P.C.B./Flange

TERMINATIONS:

P.C. Spills

P.C. Spills

COLOURS:

No suffix (Black), /WH (White), /GY (Grey)

No suffix (Black), /WH (White), /GY (Grey)

Max. Rating:

10A, 250V AC
(UL & CSA 15A, 250V AC)10A, 250V AC
(UL & CSA 15A, 250V AC)

Contact Resistance:

<10mΩ

<10mΩ

Insulation Resistance:

>10⁹ MΩ>10⁹ MΩ

A.C. Breakdown:

Contact-Contact 5.4kV. Contacts-Panel 10kV

Contact-Contact 5.4kV. Contacts-Panel 10kV

Operating Temp. Range:

-40°C to +70°C
+70°C-40°C to +70°C
+70°C

Mouldings:

Nylon, Flammability Rating UL94V-0

Nylon, Flammability Rating UL94V-0

Contacts:

Brass: Plugs, Nickel Plated.
Spills, Tin PlatedBrass: Plugs, Nickel Plated.
Spills, Tin Plated

Approvals:



Accessories / Notes:

Standard without cover.
With cover add /12132 to P.No
VDE approvals for black version onlyStandard without cover.
With cover add /12132 to P.No.
VDE approvals for black version only

Mating Connectors:

PX0587, PX0587/SE, PX0588

PX0587, PX0587/SE, PX0588

RoHS

Compliant

Compliant

Flanged Mount Fused Inlet



PF0001/48 (P.F.1/187) PF0002/28

- Single Fuse 5 x 20mm
- Spare Fuse Facility
- 2.8, 4.8 or 6.3mm Tabs
- 10A, 250V AC
- Fuse Contacts Isolated (PF0002)

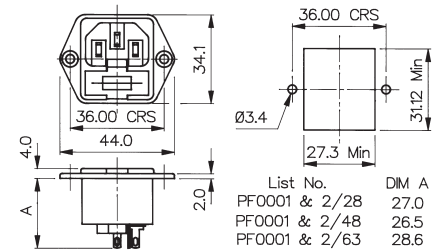





PC Flanged Mount Fused Inlet

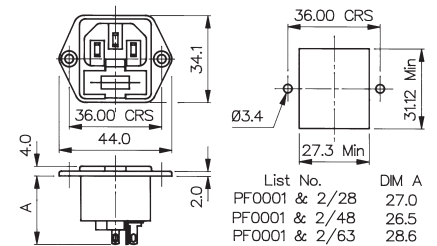

PF0001/PC

- Single Fuse 5 x 20mm
- Spare Fuse Facility
- PC Spills - Horizontal
- 10A, 250V AC



| Specifications | PF0001/Termination/Colour | PF0001/PC/Colour | PF0002/Termination/Colour |
|------------------------|------------------------------------------------------------------------------------------------|----------------------------------------------------------------------------------------------------------|------------------------------------------------------------------------------------------------------------------------------|
| FIXING(Panel): | Flange | P.C.B./Flange | Flange |
| TERMINATIONS: | /28 (2.8mm solder), /48 (4.8mm tab) /63 (6.3mm tab) | P.C. Spills | /28 (2.8mm solder), /48 (4.8mm tab) /63 (6.3mm tab) |
| COLOURS: | No suffix (Black), /WH (White), /GY (Grey) | No suffix (Black), /WH (White), /GY (Grey) | No suffix (Black), /WH (White), /GY (Grey) |
| Max. Rating: | 10A, 250V AC | 10A, 250V AC | 10A, 250V AC |
| Max. Fuse Rating: | 2.5W/10A, 250V AC | 2.5W/10A, 250V AC | 2.5W/10A, 250V AC |
| Contact Resistance: | <10mΩ (<15mΩ including Fuseholder) | <10mΩ (<15mΩ including Fuseholder) | <10mΩ |
| Insulation Resistance: | >10 ³ MΩ | >10 ³ MΩ | >10 ³ MΩ |
| AC Breakdown: | Contact-Contact 5.5kV. Contacts-Panel 4kV | Contact-Contact 5.5kV. Contacts-Panel 4kV | Contact-Contact 5.5kV. Contacts-Panel 4kV |
| Operating Temp.: | -40°C to +70°C | -40°C to +70°C | -40°C to +70°C |
| Max. Plug Temp.: | +70°C | +70°C | +70°C |
| Mouldings: | +70°C | Nylon, Flammability Rating UL94V-0 | Nylon, Flammability Rating UL94V-0 |
| Contacts: | Nylon, Flammability Rating UL94V-0 Brass: Plugs, Nickel Plated. Tabs, Tin Plated | Brass: Plugs, Nickel Plated. Tabs, Tin Plated | Brass: Plugs, Nickel Plated. Tabs, Tin Plated |
| Approvals: |  |  |  |
| Accessories / Notes: | P.No. 11987, KT0009 (See Pages 21 and 23) VDE and ENEC approval for black versions only. | KT0009 (front of panel mounting only) (See Page 21) VDE and ENEC approval for black versions only. | P.No. 11987, KT0009 (See Pages 21 and 23) (Note: Fuse contact isolated) VDE and ENEC approval for black versions only. |
| Mating Connectors: | PX0587, PX0587/SE, PX0588 | PX0587, PX0587/SE, PX0588 | PX0587, PX0587/SE, PX0588 |
| RoHS | Compliant | Compliant | Compliant |

Snap Fit to Panel Fused Inlet



PF0011/10/28

- Single Fuse 5 x 20mm
- Spare Fuse Facility
- Panel Thickness 1, 1.5, 2.0 or 3.0mm
- 2.8, 4.8 or 6.3mm Tabs
- 10A, 250V AC

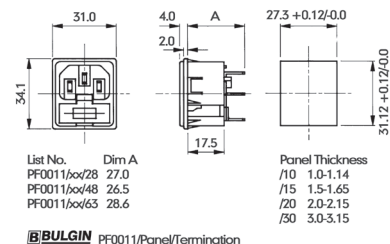

PC Snap Fit to Panel Fused Inlet



PF0011/10/PC

- Single Fuse 5 x 20mm
- Spare Fuse Facility
- Panel Thickness 1, 1.5, 2.0 or 3.0mm
- PC Spills
- 10A, 250V AC

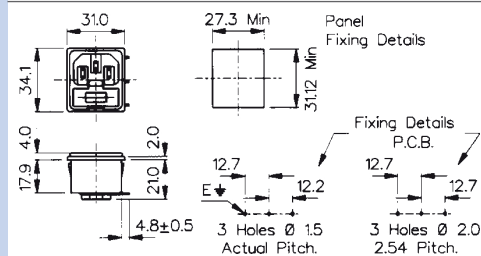

| Specifications | PF0011/Fixing/Termination/Colour | PF0011/Fixing/PC/Colour |
|------------------------|-----------------------------------------------------------------------------|--------------------------------------------------------|
| FIXINGS: | Snap fit, /10 (1mm), /15 (1.5mm), /20 (2mm), /30 (3mm) | Snap fit, /10 (1mm), /15 (1.5mm), /20 (2mm), /30 (3mm) |
| TERMINATIONS: | /28 (2.8mm solder), /48 (4.8mm tab) /63 (6.3mm tab) | P.C. Spills |
| COLOURS: | No suffix (Black), /WH (White), /GY (Grey) | No suffix (Black), /WH (White), /GY (Grey) |
| Max. Rating: | 10A, 250V AC | 10A, 250V AC |
| Max. Fuse Rating | 2.5W/10A, 250V AC | 2.5W/10A, 250V AC |
| Contact Resistance: | <10mΩ (<15mΩ including Fuseholder) | <10mΩ (<15mΩ including Fuseholder) |
| Insulation Resistance: | >10 ⁹ MΩ | >10 ⁹ MΩ |
| AC Breakdown: | Contact-Contact 5.5kV. Contacts-Panel 4kV | Contact-Contact 5.5kV. Contacts-Panel 4kV |
| Operating Temp. | -40°C to +70°C | -40°C to +70°C |
| Max. Plug Temp.: | +70°C | +70°C |
| Mouldings: | Nylon, Flammability Rating UL94V-0 | Nylon, Flammability Rating UL94V-0 |
| Contacts: | Brass: Plugs, Nickel Plated. Tabs, Tin Plated | Brass: Plugs, Nickel Plated. Spills, Tin Plated |
| Approvals: | | |
| Accessories / Notes: | P.No. 11987 (See Page 23) VDE and ENEC approval for black versions only. | VDE and ENEC approval for black versions only. |
| Mating Connectors: | PX0587, PX0587/SE, PX0588 | PX0587, PX0587/SE, PX0588 |
| RoHS | Compliant | Compliant |

Flanged Mount Fused Inlet

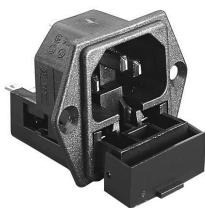

PF0030/28

- Twin Fused 5 x 20mm
- 2.8, 4.8 or 6.3mm Tabs
- 10A, 250V a.c.

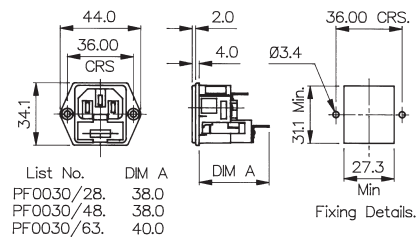

PC Flanged Mount Fused Inlet



PF0030/PC

- Twin Fused 5 x 20mm
- PC Spills
- 10A, 250V a.c.

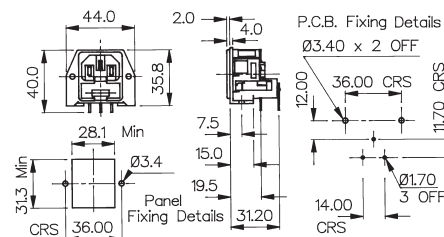

Snap Fit to Panel Fused Inlet



PF0033/10/28

- Twin Fused 5 x 20mm
- Fits Panel Thickness 1.0, 1.5, 2.0 or 3.0mm
- 2.8, 4.8 or 6.3mm Tabs
- 10A, 250V AC

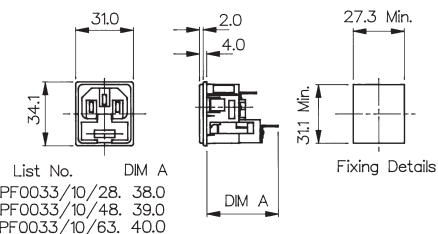

| Specifications | PF0030/Termination | PF0030/PC | PF0033/Fixing/Termination |
|----------------------------|--------------------------------------------------------|-----------------------------------------------|--------------------------------------------------------|
| FIXINGS(Panel): | Flange | P.C.B/Flange | Snap fit, /10 (1mm), /15 (1.5mm), /20 (2mm), /30 (3mm) |
| TERMINATIONS: | /28 (2.8mm solder), /48 (4.8mm tab) /63 (6.3mm tab) | P.C. Spills | /28 (2.8mm solder), /48 (4.8mm tab) /63 (6.3mm tab) |
| Max. Rating: | 10A, 250V AC | 10A, 250V AC | 10A, 250V AC |
| Contact Resistance: | <15m Ω (per Contact) | <15m Ω (per Contact) | <15m Ω (per Contact) |
| Insulation Resistance: | >10 ⁴ M Ω | >10 ⁴ M Ω | >10 ⁴ M Ω |
| AC Breakdown: | Contact-Contact 6kV. Contacts-Panel 5kV | Contact-Contact 6kV. Contacts-Panel 5kV | Contact-Contact 6kV. Contacts-Panel 5kV |
| Max. Dissipation Per Fuse: | 2.5W | 2.5W | 2.5W |
| Operating Temp. | -20°C to +70°C | -20°C to +70°C | -20°C to +70°C |
| Max. Plug Temp.: | +70°C | +70°C | +70°C |
| Mouldings: | Nylon, Flammability Rating UL94V-0 | Nylon, Flammability Rating UL94V-0 | Nylon, Flammability Rating UL94V-0 |
| Contacts: | Brass: Plugs, Nickel Plated. Tabs, Tin Plated | Brass: Plugs, Nickel Plated. Tabs, Tin Plated | Brass: Plugs, Nickel Plated. Tabs, Tin Plated |
| Accessories / Notes: | KT0009 (See Page 21) | | |
| Mating Connectors: | PX0587, PX0587/SE, PX0588 | PX0587, PX0587/SE, PX0588 | PX0587, PX0587/SE, PX0588 |
| RoHS | Compliant | Compliant | Compliant |

Straight Female Connector



PX0597

- Cable Mounting
- Hot Condition
- Mates with PX0590 and PX0595
- Screw Terminals
- 10A, 250V AC

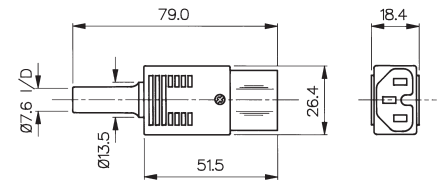

Flange Mount Inlet



PX0590/28

- Hot Condition
- 2.8 or 6.3mm Tabs
- 10A, 250V AC (15A, 250V AC UL & CSA)

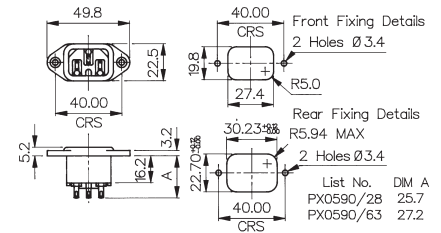





Snap Fit to Panel Inlet

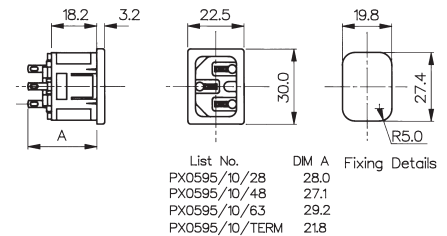

PX0595/10/28

- Hot Condition
- Panel Thickness 1, 1.5, 2.0 or 3.0mm
- 2.8, 4.8, 6.3mm Tabs or Screw Terminals
- 10A, 250V AC (15A, 250V AC cULus)



| Specifications | PX0597/Colour | PX0590/Termination/Colour | PX0595/Fixing/Termination/Colour |
|---------------------------------------------------------|-------------------------------------------------------------------------------------|---------------------------------------------------------------------------------------------|------------------------------------------------------------------------------------------------------------|
| FIXINGS(Panel): | | Flange | Snap fit, /10 (1mm), /15 (1.5mm), /20 (2mm), /30 (3mm) |
| TERMINATIONS: | Screw Terminals | /28 (2.8mm solder), /63 (6.3mm tab) | /28 (2.8mm solder), /48 (4.8mm tab), /63 (6.3mm tab), /TERM (screw) |
| COLOURS: | No suffix (Black), /WH (White), /GY (Grey) | No suffix (Black), /WH (White), /GY (Grey) | No suffix (Black), /WH (White), /GY (Grey) |
| Max. Rating: | 10A, 250V AC | 10A, 250V AC (UL & CSA 15A, 250V AC) | 10A, 250V AC (cULus 15A, 250V AC) |
| Contact Resistance: | <10mΩ | <10mΩ | <10mΩ |
| Insulation Resistance: | >10 ³ MΩ | >10 ³ MΩ | >10 ³ MΩ |
| AC Breakdown: | Contact-Contact 4.5kV. Contacts-Accessible Parts 4kV | Contact-Contact 5kV. Contacts-Panel 10kV | Contact-Contact 5kV. Contacts-Panel 5.4kV |
| Operating Temp. Max. Plug Temp: Withdrawal Force: | -40°C to +70°C 10N (Min.) 50N (Max.) | -40°C to +70°C +120°C | -40°C to +70°C +120°C |
| Mouldings: Contacts: | Nylon, Flammability Rating UL94V-0 Brass, Clean | Nylon, Flammability Rating UL94V-0 Brass, Plugs Nickel Plated. Tabs, Tin Plated | Nylon, Flammability Rating UL94V-0 Brass, Plugs Nickel Plated. Tabs, Tin Plated |
| Approvals: |  |  |  |
| Accessories / Notes: | VDE and ENEC approval for black and white versions only. | P.No. 11328, KT0006 (See Pages 21 and 23) VDE and ENEC approval for black versions only. | ENEC10/VDE currenty pending P.No. 11328 (See Page 23) VDE and ENEC approval for black versions only. |
| Mating Connectors: | PX0590, PX0595 | PX0597 | PX0597 |
| RoHS | Compliant | Compliant | Compliant |

Flanged Mount Fused Inlet



PF0006/28

- Single Fuse 5 x 20mm
- Two Plug Class II (No Earth Plug)
- 2.8, 4.8 or 6.3mm Tabs
- 10A, 250V AC

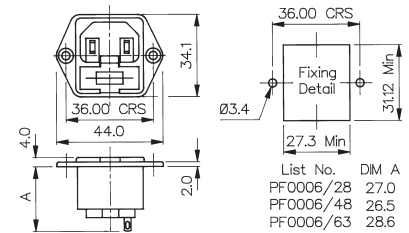

Flanged Mount Fused Inlet



PF0007/28

- Single Fuse 5 x 20mm (Fuse Contacts Isolated)
- Two Plug Class II (No Earth Plug)
- 2.8, 4.8 or 6.3mm Tabs
- 10A, 250V AC

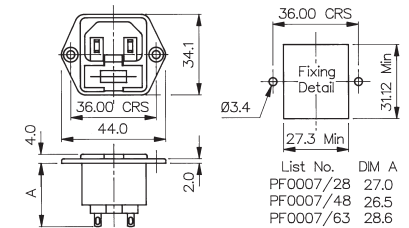





Snap Fit to Panel Fused Inlet

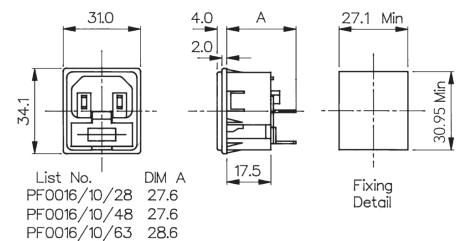

PF0016/10/28

- Single Fuse 5 x 20mm
- Two Plug Class II (No Earth Plug)
- Fits Panel Thickness 1.0, 1.5, 2.0 or 3.0mm
- 2.8, 4.8 or 6.3mm Tabs
- 10A, 250V AC



| Specifications | PF0006/Termination/Colour | PF0007/Termination/Colour | PF0016/Fixing/Termination/Colour |
|-------------------------------------|-------------------------------------------------------------------------------------|---------------------------------------------------------------------------------------------------------------|---------------------------------------------------------------------------------------|
| FIXING(Panel): | Flange | Flange | Snap fit, /10 (1mm), /15 (1.5mm), /20 (2mm), /30 (3mm) |
| TERMINATIONS: | /28 (2.8mm solder), /48 (4.8mm tab) /63 (6.3mm tab) | /28 (2.8mm solder), /48 (4.8mm tab) /63 (6.3mm tab) | /28 (2.8mm solder), /48 (4.8mm tab) /63 (6.3mm tab) |
| COLOURS: | No suffix (Black), /WH (White), /GY (Grey) | No suffix (Black), /WH (White), /GY (Grey) | No suffix (Black), /WH (White), /GY (Grey) |
| Max. Rating: | 10A, 250V AC | 10A, 250V AC | 10A, 250V AC. |
| Contact Resistance: | <10mΩ (<15mΩ including Fuseholder) | <10mΩ | <10mΩ (<15mΩ including Fuseholder) |
| Insulation Resistance: | >10 ⁹ MΩ | >10 ⁹ MΩ | >10 ⁹ MΩ |
| AC Breakdown: | Contact-Contact 5.5kV. Contacts-Panel 4kV | Contact-Contact 5.5kV. Contacts-Panel 4kV | Contact-Contact 5.5kV. Contacts-Panel 4kV |
| Operating Temp. Max. Plug Temp.: | -40°C to +70°C +70°C | -40°C to +70°C +70°C | -40°C to +70°C +70°C |
| Mouldings: | Nylon, Flammability Rating UL94V-0 | Nylon, Flammability Rating UL94V-0 | Nylon, Flammability Rating UL94V-0 |
| Contacts: | Brass: Plugs, Nickel Plated. Tabs, Tin Plated | Brass: Plugs, Nickel Plated. Tabs, Tin Plated | Brass: Plugs, Nickel Plated. Tabs, Tin Plated |
| Approvals: |  |  |  |
| Accessories / Notes: | P.No. 11987 (See Page 23) VDE and ENEC approval for black versions only. | P.No. 11987 (See Page 23) (Note: Fuse contacts isolated) VDE and ENEC approval for black versions only. | P.No. 11987 (See Page 23) VDE and ENEC approval for black versions only. |
| Mating Connectors: | PX0587, PX0587/SE, PX0588 | PX0587, PX0587/SE, PX0588 | PX0587, PX0587/SE, PX0588 |
| RoHS | Compliant | Compliant | Compliant |

Straight Male Connector



PX0686

- Cable Mounting
- Rewirable
- Screw Terminals
- 10A, 250V AC

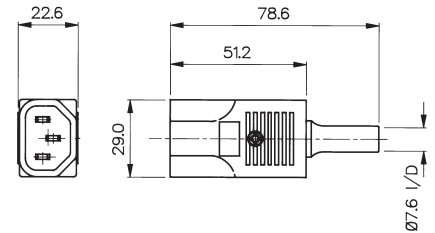

Side Entry Male Connector



PX0686/SE

- Cable Mounting
- Rewirable
- Screw Terminals
- 10A, 250V AC

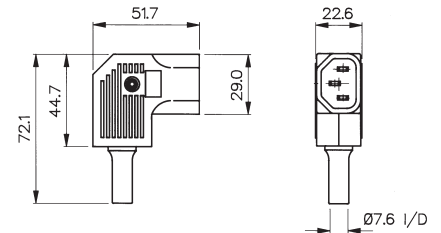



Right Angle Male Connector

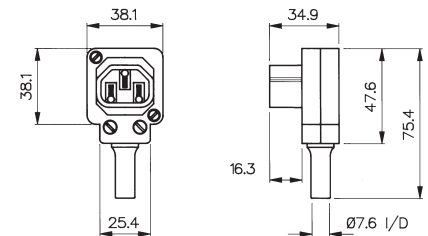

PX0685

- Cable Mounting
- Four Position Cable Entry
- Rewirable
- Screw Terminals
- 10A, 250V AC



| Specifications | PX0685/Colour | PX0686/Colour | PX0686/SE/Colour |
|------------------------|-------------------------------------------------------------------------------------|-------------------------------------------------------------------------------------|---------------------------------------------------------------------------------------|
| FIXING(Panel): | Screw Terminals | Screw Terminals | Screw Terminals |
| Max. Rating: | 10A, 250V AC | 10A, 250V AC | 10A, 250V AC |
| COLOURS: | No suffix (Black), /WH (White), /GY (Grey) | No suffix (Black), /WH (White), /GY (Grey) | No suffix (Black), /WH (White), /GY (Grey) |
| Contact Resistance: | <10mΩ | <10mΩ | <10mΩ |
| Insulation Resistance: | >10 ⁴ MΩ | >10 ⁴ MΩ | >10 ⁴ MΩ |
| AC Breakdown: | Contact-Contact 5.2kV. Contacts-Accessible Parts 6kV | Contact-Contact 5kV. Contacts-Accessible Parts 5kV | Contact-Contact 5kV. Contacts-Accessible Parts 5kV |
| Operating Temp. | -40°C to +70°C | -40°C to +70°C | -40°C to +70°C |
| Withdrawal Force: | 10N (Min.) 50N (Max.) | 10N (Min.) 50N (Max.) | 10N (Min.) 50N (Max.) |
| Mouldings: | Nylon, Flammability Rating UL94V-0 | Nylon, Flammability Rating UL94V-0 | Nylon, Flammability Rating UL94V-0 |
| Contacts: | Brass, Nickel Plated. | Brass, Nickel Plated. | Brass, Nickel Plated. |
| Approvals: |  |  |  |
| Accessories / Notes: | Unique octagon module allows choice of 4 cable positions | VDE and ENEC approval for black and white versions only. | VDE and ENEC approval for black and white versions only. |
| Mating Outlets: | PX0675, PX0695, PX0578, PX0783, PX0793, PX0793/1 | PX0675, PX0695, PX0578, PX0783, PX0793, PX0793/1, PX0716 | PX0675, PX0695, PX0578, PX0783, PX0793, PX0793/1, PX0716 |
| RoHS | Compliant | Compliant | Compliant |

Snap Fit to Panel Inlet/ Outlet



PX0716/48

- Inlet/Outlet combination
- Panel Thickness 1.2mm
- 4.8mm tabs
- 10A, 250V AC
(15A, 250V AC UL & CSA)

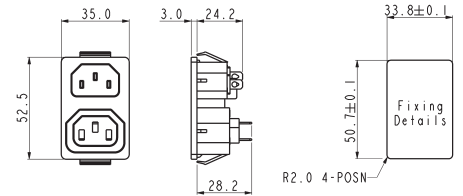

| Specifications | PX0716/Termination |
|------------------------|-------------------------------------------------------------------------------------|
| FIXINGS: | Snap fit 1.2mm accommodation |
| TERMINATIONS: | /48 (4.8mm tab) |
| Max. Rating: | 10A, 250V AC (UL 15A, 125V AC) |
| Insulation Resistance: | >100MΩ (500V DC., 1 min.) |
| Dielectric Strength: | 2kV (50Hz, 1 min.) |
| Operating Temp. | -20°C to +70°C |
| Max. Plug Temp: | +70°C |
| Mouldings: | Nylon 66, Flammability Rating UL94V-0 |
| Contacts: | Brass, Tin Plated |
| Approvals: |  |
| Accessories / Notes: | |
| Mating With: | PX0587, PX0587/SE, PX0588, PX0686, PX0686/SE |
| RoHS | Compliant |

Flange Mount Outlet



PX0675/28

- 2.8mm or 6.3mm Tabs
- 10A, 250V AC
(15A, 250V AC UL & CSA).

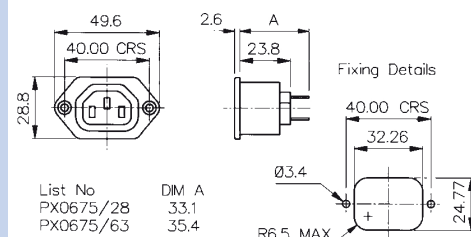



PC Flange Rear Mount Outlet

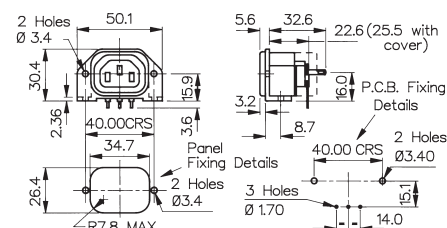

PX0675/PC

- PC Spills
- 10A, 250V AC
(15A, 250V AC UL & CSA)



| Specifications | PX0675/Termination/Colour | PX0675/PC/Colour |
|------------------------|----------------------------------------------------------------------------------------------------------------------------------|----------------------------------------------------------------------------------------------------------------------------------|
| FIXINGS: | Flange | P.C.B./Flange |
| TERMINATIONS: | /28 (2.8mm solder), /48 (4.8mm tab), /63 (6.3mm tab) | P.C. Spills |
| COLOURS: | No suffix (Black), /WH (White), /GY (Grey) | No suffix (Black), /WH (White), /GY (Grey) |
| Max. Rating: | 10A, 250V AC (UL & CSA 15A, 250V AC) | 10A, 250V AC (UL & CSA 15A, 250V AC) |
| Contact Resistance: | <10mΩ | <10mΩ |
| Insulation Resistance: | >10 ⁴ MΩ | >10 ⁴ MΩ |
| AC Breakdown: | Contact-Contact 7kV. Contacts-Panel 9kV | Contact-Contact 4kV. Contacts-Panel 9kV |
| Operating Temp. | -40°C to +70°C | -40°C to +70°C |
| Mouldings: | Nylon, Flammability Rating UL94V-0 | Nylon, Flammability Rating UL94V-0 |
| Contacts: | Brass, Tin Plated | Brass, Tin Plated |
| Approvals: |  UR approvals does not cover 4.8mm tab option |  |
| Accessories / Notes: | P.No. 12075, KT0006, 14228 (See Pages 21 & 22) VDE and ENEC approval for black versions only. | Standard without cover. With cover add /12599 to P.No., 14228 (see page 22) VDE and ENEC approval for black versions only. |
| Mates with: | PX0685, PX0686, PX0686/SE | PX0685, PX0686, PX0686/SE |
| RoHS | Compliant | Compliant |

Snap Fit to Panel Outlet



PX0695/10/28

- Panel Sizes 1, 1.5, 2.0 or 3.0mm
- 2.8 or 6.3mm Tabs
- 10A, 250V AC (15A, 250V AC UL & CSA)

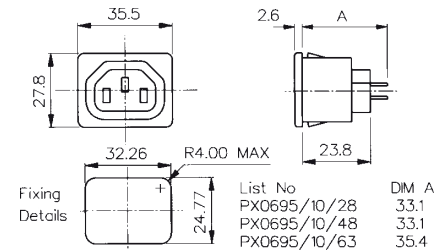



PC Snap Fit to Panel Outlet

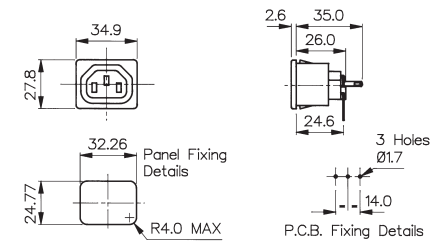

PX0695/10/PC

- Panel Thickness 1, 1.5, 2.0 or 3.0mm
- PC Spills
- 10A, 250V AC (15A, 250V AC UL & CSA)



| Specifications | PX0695/Fixing/Termination/Colour | PX0695/Fixing/PC/Colour |
|------------------------|-----------------------------------------------------------------------------------------|-------------------------------------------------------------------------------------|
| FIXINGS: | Snap fit, /10 (1mm), /15 (1.5mm), /20 (2mm), /30 (3mm) | Snap fit, /10 (1mm), /15 (1.5mm), /20 (2mm), /30 (3mm) |
| TERMINATIONS: | /28 (2.8mm solder), /63 (6.3mm tab) | P.C. Spills |
| COLOURS: | No suffix (Black), /WH (White), /GY (Grey) | No suffix (Black), /WH (White), /GY (Grey) |
| Max. Rating: | 10A, 250V AC (UL & CSA 15A, 250V AC) | 10A, 250V AC (UL & CSA 15A, 250V AC) |
| Contact Resistance: | <10mΩ | <10mΩ |
| Insulation Resistance: | >10 ⁴ MΩ | >10 ⁴ MΩ |
| AC Breakdown: | Contact-Contact 7kV. Contacts-Panel 9kV | Contact-Contact 4kV. Contacts-Panel 9kV |
| Operating Temp. | -40°C to +70°C | -40°C to +70°C |
| Mouldings: | Nylon, Flammability Rating UL94V-0 | Nylon, Flammability Rating UL94V-0 |
| Contacts: | Brass, Tin Plated | Brass, Tin Plated |
| Approvals: |  |  |
| Accessories / Notes: | P.No. 12075, 14228 (See Page 22 & 23) VDE and ENEC approval for black versions only. | P.No. 14228 (see page 22) VDE and ENEC approval for black versions only. |
| Mates with: | PX0685, PX0686, PX0686/SE, | PX0685, PX0686, PX0686/SE, |
| RoHS | Compliant | Compliant |

Snap Fit to Panel Outlet

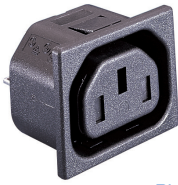

PX0783/10/28

- Shuttered
- Panel Thickness 1, 1.5, 2.0 or 3.0mm
- 2.8, 4.8 or 6.3mm Tabs
- 10A, 250V AC
(15A, 250V AC UL & CSA)

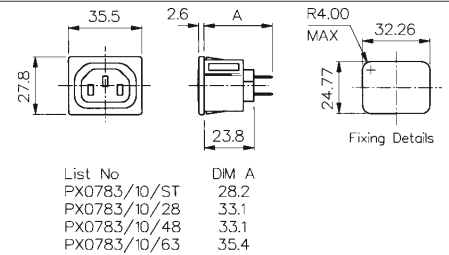

Flange Mount Outlet



PX0793/28

- Shuttered
- 2.8, 4.8 or 6.3mm Tabs
- 10A, 250V AC
(15A, 250V AC UL & CSA)

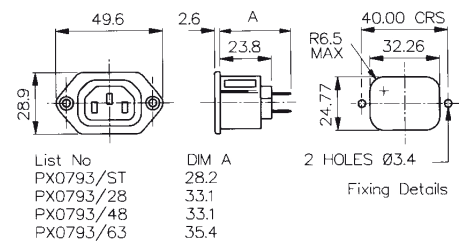





PC Snap Fit to Panel Outlet

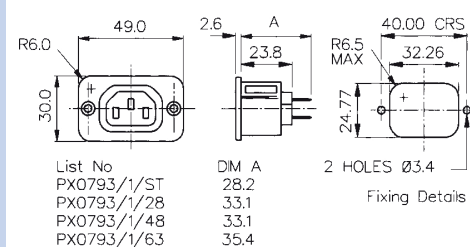

PX0793/1/Termination

- Shuttered
- Rectangular Flange Mount Outlet
- 2.8, 4.8 or 6.3mm Tabs
- 10A, 250V AC
(15A, 250V AC UL & CSA)



| Specifications | PX0783/Fixing/Termination/Colour | PX0793/Fixing/PC/Colour | PX0793/1/Termination/Colour |
|------------------------|-----------------------------------------------------------------------------------------|--------------------------------------------------------------------------------------------------------|--------------------------------------------------------------------------------------------------------|
| FIXINGS: | Snap fit, /10 (1mm), /15 (1.5mm), /20 (2mm), /30 (3mm) | Flange | Rectangular Flange |
| TERMINATIONS: | /28 (2.8mm solder), /48 (4.8mm tab) /63 (6.3mm tab), /ST (solder) | /28 (2.8mm solder), /48 (4.8mm tab) /63 (6.3mm tab), /ST (solder) | /28 (2.8mm solder), /48 (4.8mm tab) /63 (6.3mm tab), /ST (solder) |
| COLOURS: | No suffix (Black), /WH (White), /GY (Grey) | No suffix (Black), /WH (White), /GY (Grey) | No suffix (Black), /WH (White), /GY (Grey) |
| Max. Rating: | 10A, 250V AC (UL & CSA 15A, 250V AC) | 10A, 250V AC (UL & CSA 15A, 250V AC) | 10A, 250V AC (UL & CSA 15A, 250V AC) |
| Contact Resistance: | <10mΩ | <10mΩ | <10mΩ |
| Insulation Resistance: | >10 ⁴ MΩ | >10 ⁴ MΩ | >10 ⁴ MΩ |
| AC Breakdown: | Contact-Contact 7kV. Contacts-Panel 9kV | Contact-Contact 7kV. Contacts-Panel 9kV | Contact-Contact 7kV. Contacts-Panel 9kV |
| Operating Temp. | -40°C to +70°C | -40°C to +70°C | -40°C to +70°C |
| Mouldings: | Nylon, Flammability Rating UL 94V-0 | Nylon, Flammability Rating UL 94V-0 | Nylon, Flammability Rating UL 94V-0 |
| Contacts: | Brass, Tin Plated | Brass, Tin Plated | Brass, Tin Plated |
| Approvals: |  |  |  |
| Accessories / Notes: | P.No. 12075, 14228 (See Page 22 & 23) VDE and ENEC approval for black versions only. | P.No. 12075, KT0006, 14228 (See Page 21, 22 & 23) VDE and ENEC approval for black versions only. | P.No. 12075, KT0006, 14228 (See Page 21, 22 & 23) VDE and ENEC approval for black versions only. |
| Mates with: | PX0685, PX0686, PX0686/SE | PX0685, PX0686, PX0686/SE | PX0685, PX0686, PX0686/SE |
| RoHS | Compliant | Compliant | Compliant |

Flange Mount Outlet



PX0705/28

- Two Plug Class II (No Earth Plug)
- 2.8, 4.8 or 6.3mm Tabs
- 10A, 250V AC
(15A, 250V AC UL & CSA)

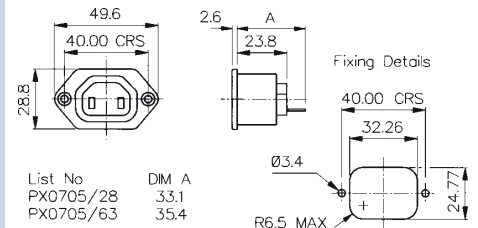



Snap Fit to Panel Outlet

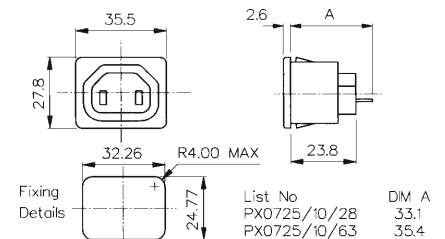

PX0725/10/28

- Two Plug Class II (No Earth Plug)
- Panel Thickness 1, 1.5, 2.0 or 3.0mm
- 2.8, 4.8 or 6.3mm Tabs
- 10A, 250V AC
(15A, 250V AC UL & CSA)



| Specifications | PX0705/Termination/Colour | PX0725/Fixing/Termination/Colour |
|------------------------|-------------------------------------------------------------------------------------|-------------------------------------------------------------------------------------|
| FIXINGS: | Flange | Snap fit, /10 (1mm), /15 (1.5mm), /20 (2mm), /30 (3mm) |
| TERMINATIONS: | /28 (2.8mm solder), /48 (4.8mm tab) /63 (6.3mm tab) | /28 (2.8mm solder), /48 (4.8mm tab) /63 (6.3mm tab) |
| COLOURS: | No suffix (Black), /WH (White), /GY (Grey) | No suffix (Black), /WH (White), /GY (Grey) |
| Max. Rating: | 10A, 250V AC (UL & CSA 15A, 250V AC) | 10A, 250V AC (UL & CSA 15A, 250V AC) |
| Contact Resistance: | <10mΩ | <10mΩ |
| Insulation Resistance: | >10 ⁴ MΩ | >10 ⁴ MΩ |
| AC Breakdown: | Contact-Contact 4kV. Contacts-Panel 9kV | Contact-Contact 7kV. Contacts-Panel 9kV |
| Operating Temp. | -40°C to +70°C | -40°C to +70°C |
| Mouldings: | Nylon, Flammability Rating UL94V-0 | Nylon, Flammability Rating UL94V-0 |
| Contacts: | Brass, Tin Plated | Brass, Tin Plated |
| Approvals: |  |  |
| Accessories / Notes: | P.No. 12075 (See Page 23) VDE and ENEC approval for black versions only. | P.No. 12075 (See Page 23) VDE and ENEC approval for black versions only. |
| RoHS | Compliant | Compliant |

C19 Straight Female Cable Connector



PX0599

- Rewirable Screw Terminals
- 16A, 250V AC
- Wire Sizes (max);
3 x 2.5mm², 3 x 12AWG
- Overall cable diameter up to 12mm

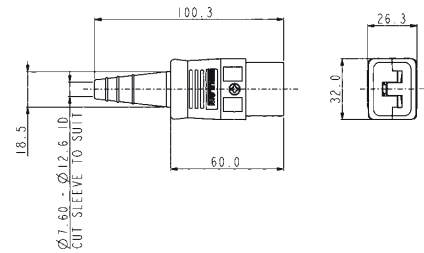

C20 Flange Mount Inlet



PX0596

- 6.3mm or 4.8mm Tabs
- 16A, 250V AC
(20A, 250V AC UL and cUL)

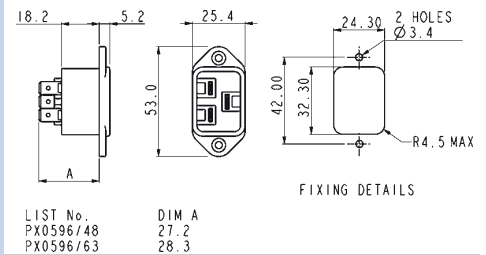







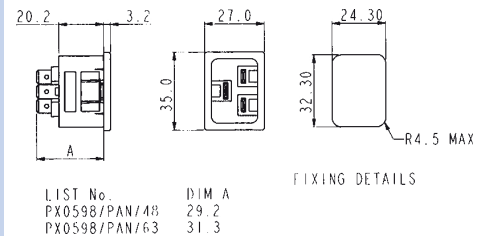

C20 Snap Fit to Panel Inlet



PX0598

- Fits panel Thickness 1, 1.5, 2.0 or 3.0mm
- 6.3mm or 4.8mm Tabs
- 16A, 250V AC
(20A, 250V AC UL and cUL)



| Specifications | PX0599 | PX0596/Termination | PX0598/Fixing/Termination |
|--------------------------------------------|-------------------------------------------------------------------------------------|-------------------------------------------------------------------------------------------------------------------------------------------------------------------------------------------------------------------------------------------------------------|-------------------------------------------------------------------------------------------------------------------------------------------------------------------------------------------------------------------------------------------------------------------|
| FIXINGS (Panel): | | Flange | Snap Fit, /10 (1mm), /15 (1.5mm), /20 (2mm), /30 (3mm) |
| TERMINATIONS: | Screw Terminals | /63 (6.3mm tab), /48 (4.8mm tab) | /63 (6.3mm tab), /48 (4.8mm tab) |
| Max. Rating: | 16A, 250V AC | 16A, 250V AC 20A, 250V AC UL and cUL | 16A, 250V AC 20A, 250V AC UL and cUL |
| Insulation Resistance: | >5MΩ | >10 ⁶ MΩ | >10 ⁶ MΩ |
| Dielectric Strength Between contacts: | 1.5kV AC | 1.5kV AC | 1.5kV AC |
| Between contacts & accessible surfaces: | 3kV C | 3kV AC | 3kV AC |
| Operating Temp. Range: | -40°C to +70°C | -40°C to +70°C | -40°C to +70°C |
| Max. Plug Temp.: | | 70°C | 70°C |
| Withdrawal Force: | 15N Min, 60N Max. | | |
| Mouldings: | Nylon, Flammability Rating UL94V-0 | Nylon, Flammability Rating UL94V-0 | Nylon, Flammability Rating UL 94V-0 |
| Contacts: | Brass, Clean | Plugs: Brass, Nickel Plated Tabs: Brass, Tin Plate | Plugs: Brass, Nickel Plated Tabs: Brass, Tin Plated |
| Approvals: |  |    |    |
| Mating Connectors: | C20 Inlets; PX0596 Flange and PX0598 Snapfit | PX0599 Rewirable Connector | PX0599 Rewirable Connector |
| Accessories: | | KT0012, P.No. 14064 (see Pages 21 & 23) | P.No. 14064 (see Page 23) |
| RoHS | Compliant | Compliant | Compliant |

Retaining Clip



KT0006
(Shown with PX0580 & PX0587)

- Prevents Accidental Removal
- Fits flanged inlets

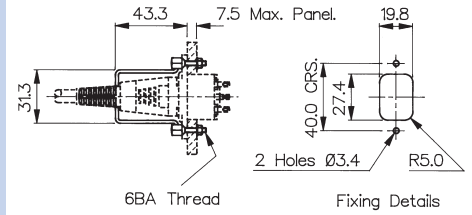

Retaining Clip

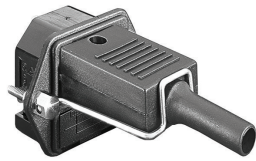

KT0009
(Shown with PF0001 & PX0587)

- Prevents Accidental Removal
- Fits fused flanged inlets

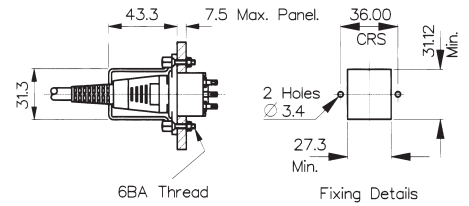

Retaining Clip



KT0012
(Shown with PX0596 & PX0599)

- Prevents Accidental Removal
- For use with PX0596 flanged inlet and PX0599 connector

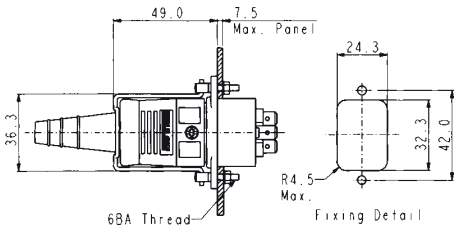

Specifications

KT0006

Retaining Clip to prevent accidental removal of connector.

Fits: PX0580 + PX0587 PX0590 + PX0597
PX0690 + PX0587
PX0675 + PX0686
PX0793 + PX0686
PX0793/1 + PX0686

KT0009

Retaining Clip to prevent accidental removal of connector.

Fits: PF0001+ PX0587
PF0001/PC +PX0587
PF0002 + PX0587
PF0030 + PX0587

KT0012

Retaining Clip to prevent accidental removal of connector.

Fits: PX0596 + PX0599

Material:

Clip: Stainless Steel, other parts Brass, Nickel Plated

Clip: Stainless Steel, other parts Brass, Nickel Plated

Clip: Stainless Steel, other parts Brass, Nickel Plated

RoHS

Compliant

Compliant

Compliant

Blanking Cover

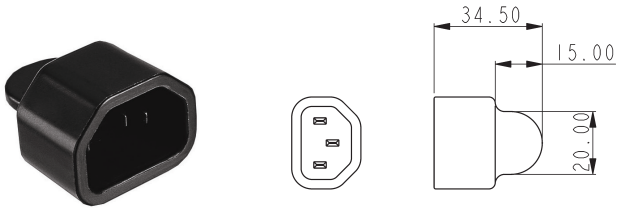

PNo 14228

Insulation Boot

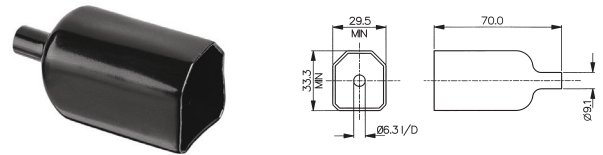

PNo 14317

- Blanking covers
- Protects Front of Outlet Connector
- Protects Against Accidental Electric Shock

- PVC Insulation Boots
- Protects Rear of Connector
- Protects Against Accidental Electric Shock

| Specifications | P.No. 14228 | P.No. 14340 | P.No. 14317 |
|-----------------------|-------------------------------------------------------------------------------------|--------------------------------------------------------|-------------------------------------------------------------------|
| | Blanking cover for PX0578, PX0675, PX0695, PX0783, PX0793, PX0716 | Insulation boot for PS20, PS21, PS25, PS26 | Insulation boot for PF0030, PF0033 (except /PC versions) |
| Operating Temp: | -40°C to +70°C | -20°C to +60°C | -20°C to +60°C |
| Max. Working Voltage: | 250V AC | 250V AC | 250V AC |
| Flash Tested: | 2kV AC | 2kV AC | 2kV AC |
| Material: | Nylon | P.V.C. | P.V.C. |
| Flammability Rating: | UL94V-0 | UL94V-0 | UL94V-0 |
| RoHS | Compliant | Compliant | Compliant |

Insulation Boot

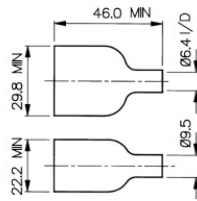

PNo 11328

Insulation Boot

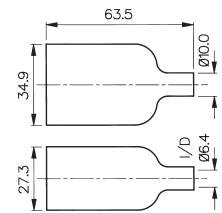

PNo 12075

Insulation Boot

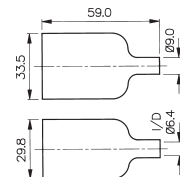

PNo 11987

Insulation Boot

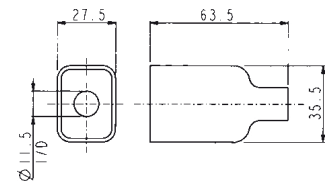

PNo 14064

- PVC Insulation Boots
- Protects Rear of Connector
- Protects Against Accidental Electric Shock

| Specifications | P.No. 11328 | P.No. 11987 | P.No. 12075 | P.No. 14064 |
|-----------------------|--------------------------------------------------------------------------|---------------------------------------------------------------------------------------------------------------------------|----------------------------------------------------------------------------------------------------------------------------|------------------------------------------|
| | Insulation boot for PX0575, PX0579, PX0580 PX0590, PX0595 | Insulation boot for PF range PF0001, PF0002, PF0006, PF0007, PF0011, PF0016 (Except /PC versions) | Insulation boot for PX0675, PX0695, PX0705, PX0725, PX0783, PX0793, PX0793/1 (Except /PC versions) | Insulation boot for PX0596, PX0598 |
| Operating Temp: | -20°C to +60°C | -20°C to +60°C | -20°C to +60°C | -20°C to +60°C |
| Max. Working Voltage: | 250V AC | 250V AC | 250V AC | 250V AC |
| Flash Tested: | 2kV AC | 2kV AC | 2kV AC | 2kV AC |
| Material: | P.V.C. | P.V.C. | P.V.C. | P.V.C. |
| Flammability Rating: | UL94V-0 | UL94V-0 | UL94V-0 | UL94V-0 |
| RoHS | Compliant | Compliant | Compliant | Compliant |