



DIL - SOLDER TAIL INTERCONNECT

Series 116 DIL - Solder tail interconnect
2.54 mm, Solder tail, Interconnect

For mechanical and electrical interconnection, PCB stacking or elevated positioning of display modules.

Technical specs.:

Insulator: Black glass filled polyester
PCT-GF30-FR
Flammability: UL 94V-O
Sleeve: Brass CuZn36Pb3 (C36000)
Contact: Clip (4 finger); Beryllium copper (C17200)
Accepted pin Ø: 0.40 to 0.56 mm
Insertion force: 2 N typ.
Withdrawal force: 1 N typ.
(polished steel gauge Ø 0.43 mm)
Mechanical life: Min. 100 cycles
Rated current: 1 A
Contact resistance: Max. 10 mΩ
Dielectric strength: Min. 1000 V RMS

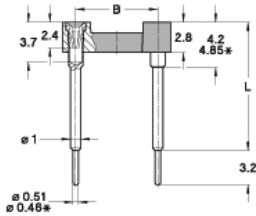

* Only for contact with L=9

Available contact length

Contact length L	XXX code
6 mm	006
7 mm	018
8 mm	003
9 mm	012
10 mm	007
11 mm	002
12 mm	008
13 mm	009
15 mm	001
18 mm	011
22 mm	004
33 mm	013

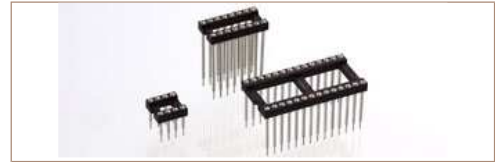

Ordering information RoHS-compliant parts

PP Plating code	Sleeve	Clip
87	Tin	Gold flash
83	Tin	Gold 0.75 µm

For complete part number replace **XXX** with the code given below left for the required contact length L

General technical specs. ...

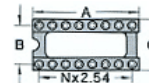

Poles	A	B	C	D	E	See	Order Codes
10	12.6	5.08	7.6				116-PP-210-41-XXX101
4	5.0	7.62	10.1				116-PP-304-41-XXX101
6	7.6	7.62	10.1				116-PP-306-41-XXX101
8	10.1	7.62	10.1				116-PP-308-41-XXX101
10	12.6	7.62	10.1				116-PP-310-41-XXX101
12	15.2	7.62	10.1				116-PP-312-41-XXX101
14	17.7	7.62	10.1				116-PP-314-41-XXX101
16	20.3	7.62	10.1				116-PP-316-41-XXX101
18	22.8	7.62	10.1				116-PP-318-41-XXX101
20	25.3	7.62	10.1				116-PP-320-41-XXX101
22	27.8	7.62	10.1				116-PP-322-41-XXX101
24	30.4	7.62	10.1				116-PP-324-41-XXX101
28	35.5	7.62	10.1				116-PP-328-41-XXX101
20	25.4	10.16	12.6				116-PP-420-41-XXX101
22	27.8	10.16	12.6				116-PP-422-41-XXX101
24	30.4	10.16	12.6				116-PP-424-41-XXX101
28	35.5	10.16	12.6				116-PP-428-41-XXX101
32	40.6	10.16	12.6				116-PP-432-41-XXX101
10	12.7	15.24	17.7				116-PP-610-41-XXX101
24	30.5	15.24	17.7				116-PP-624-41-XXX101
28	35.5	15.24	17.7				116-PP-628-41-XXX101
32	40.6	15.24	17.7				116-PP-632-41-XXX101
36	45.7	15.24	17.7				116-PP-636-41-XXX101
40	50.8	15.24	17.7				116-PP-640-41-XXX101
42	53.3	15.24	17.7				116-PP-642-41-XXX101
48	60.9	15.24	17.7				116-PP-648-41-XXX101
50	63.5	15.24	17.7				116-PP-650-41-XXX101
52	66.0	15.24	17.7				116-PP-652-41-XXX101
50	63.5	22.86	25.3				116-PP-950-41-XXX101
52	66.0	22.86	25.3				116-PP-952-41-XXX101
64	81.2	22.86	25.3				116-PP-964-41-XXX101