

P	LTR	DESCRIPTION	DATE	DWN	APVD
	C3	REVISED PER ECO-12-021315	10JAN2012	KH	JO
	D	STANDARDIZATION OF PLATING AND SPLICING	13AUG2024	GVP	KJK
	D1	ECR-25-261431	28NOV2025	ABS	PS

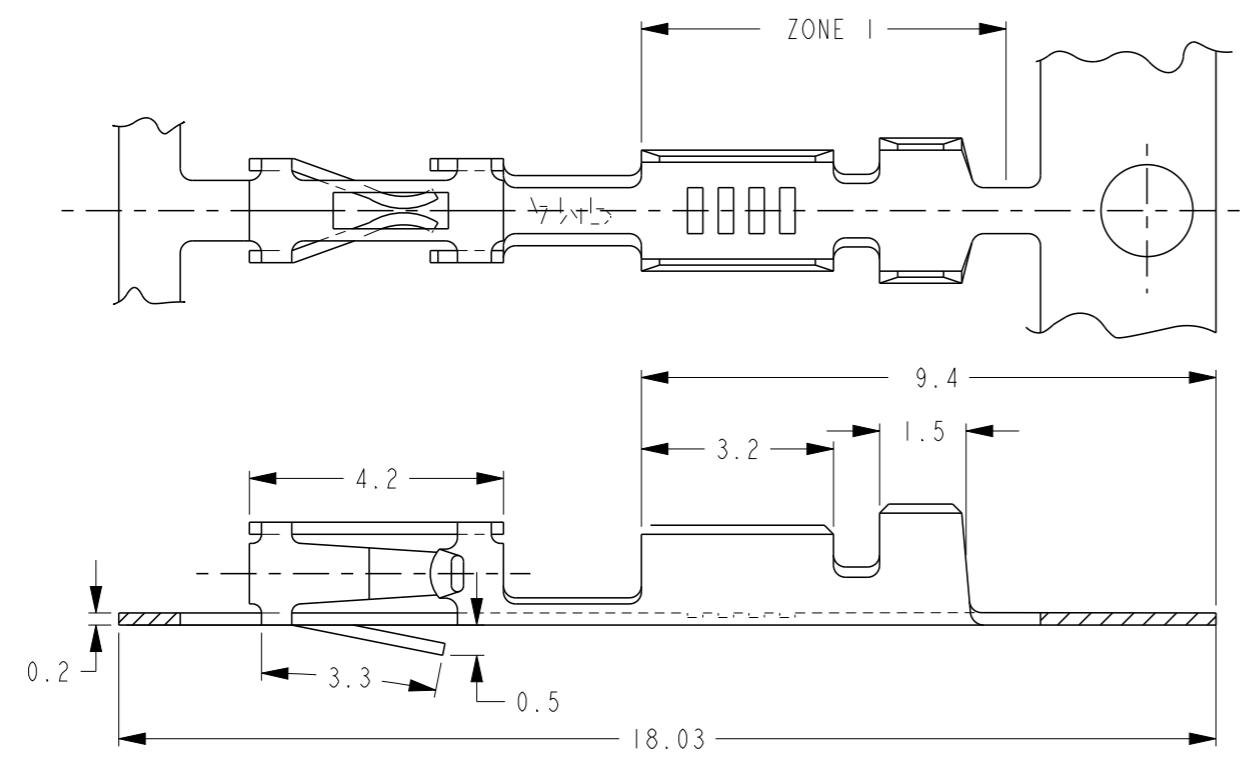
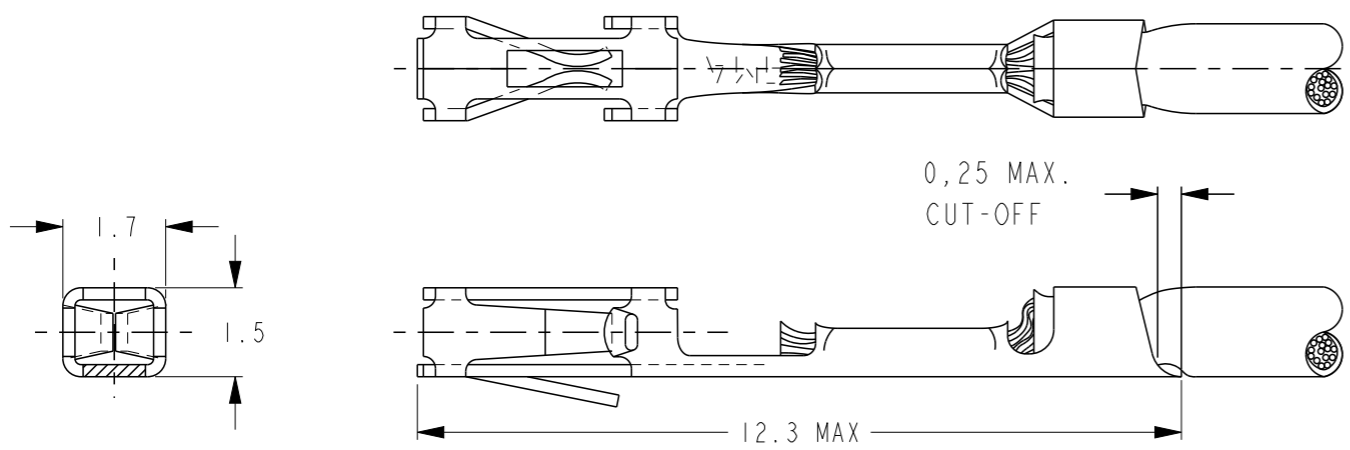

- 1 FOR MINI-APPLICATOR-CRIMPING.
- 2 UNDERCOATING: 1,25 μm Ni, SELECTIVE: 0,8 μm Au, NO GOLDFLASH.
- 3 UNDERCOATING: 1,25 μm Ni, SELECTIVE: 0,8 μm Au, GOLDFLASH ON REMAINDER (GOLDFLASH IS NOT MANDATORY ON THE PILOTED CARRIER STRIP).
- 4 PRE-TINPLATED: 2,0 μm.
- 5 ZONE 1: MATT TIN PLATED.
- 6 MATERIAL: PHOSPHORBRONZE
- 7 FOR REELFED-HANDTOOL-CRIMPING, 500 CONTACTS ON A SMALL REEL.
- 8 24-20 AWG (0,20-0,56 mm²) WITH .055 CRIMPER.
26 AWG (0,12-0,14 mm²) WITH .042 CRIMPER.
- 9 OBSOLETE PARTS: OBSOLETE CIS STREAMLINING PER D.RENAUD/D.SINISI
- 10 SPLICING - MAXIMUM 1 LOOSE END PER REEL IS ALLOWED.
- 11 OBSOLETE.

WIRE RANGE	8
INSUL. RANGE	1,4 MAX. DIA.

FINISH	LOOSE PIECE	PARTNUMBER
TIN 4	5-166309-3	166310-3
GOLD 3	5-166309-2	166310-2
GOLD 2 5	5-166309-1	166310-1
TIN 4	166309-3	166310-3
GOLD 3	166309-2	166310-2
GOLD 2 5	166309-1	166310-1

THIS DRAWING IS A CONTROLLED DOCUMENT.

DWN Rv HEUVEN 25JUNE07
CHK MvD 25JUNE07
APVD MvD
PRODUCT SPEC 108-25007
APPLICATION SPEC 114-25003
WEIGHT -

STE TE Connectivity

NAME AMPMODU MOD. V RECEPTACLE, HIGH PRESSURE, STRIP.

SIZE A3 CAGE CODE 00779 DRAWING NO C-166309 RESTRICTED TO -

CUSTOMER DRAWING SCALE NTS SHEET 1 OF 1 REV D1

DIMENSIONS:	TOLERANCES UNLESS OTHERWISE SPECIFIED:
mm	
	0 PLC ±-
	1 PLC ±-
	2 PLC ±-
	3 PLC ±-
	4 PLC ±-
	ANGLES ±-
MATERIAL -	FINISH SEE TABLE