

PRODUCT CODE: 041-02-001

MODEL: 041-136878106

INCH

T:\DRAWINGS\COUPLE\041-136878106

THIS DOCUMENT CONTAINS PROPRIETARY INFORMATION OF REXNORD INDUSTRIES, LLC. NEITHER RECEIPT NOR POSSESSION THEREOF CONFERS ANY RIGHT TO REPRODUCE OR USE, OR DISCLOSE IN WHOLE OR IN PART, ANY SUCH INFORMATION WITHOUT WRITTEN AUTHORIZATION FROM REXNORD INDUSTRIES, LLC. IT IS SUBJECT TO RETURN UPON DEMAND.

DWG# 041-136878106

| REV | DESCRIPTION | ECN# | BY | CHKD. | DATE |
|-----|---------------------------------------|------|-----|-------|---------|
| 6.1 | INITIAL RELEASE | --- | NLM | --- | 4/28/10 |
| 6.2 | CHANGED PER CUST. PRINT | --- | LAN | --- | 7/21/10 |
| 6.3 | CHANGED BORE TOL. & SET SCR. LOCATION | --- | LAN | --- | 8/5/10 |
| 6.4 | CHANGED SET SCR. LOCATION PER WEILAND | --- | LAN | --- | 8/10/10 |

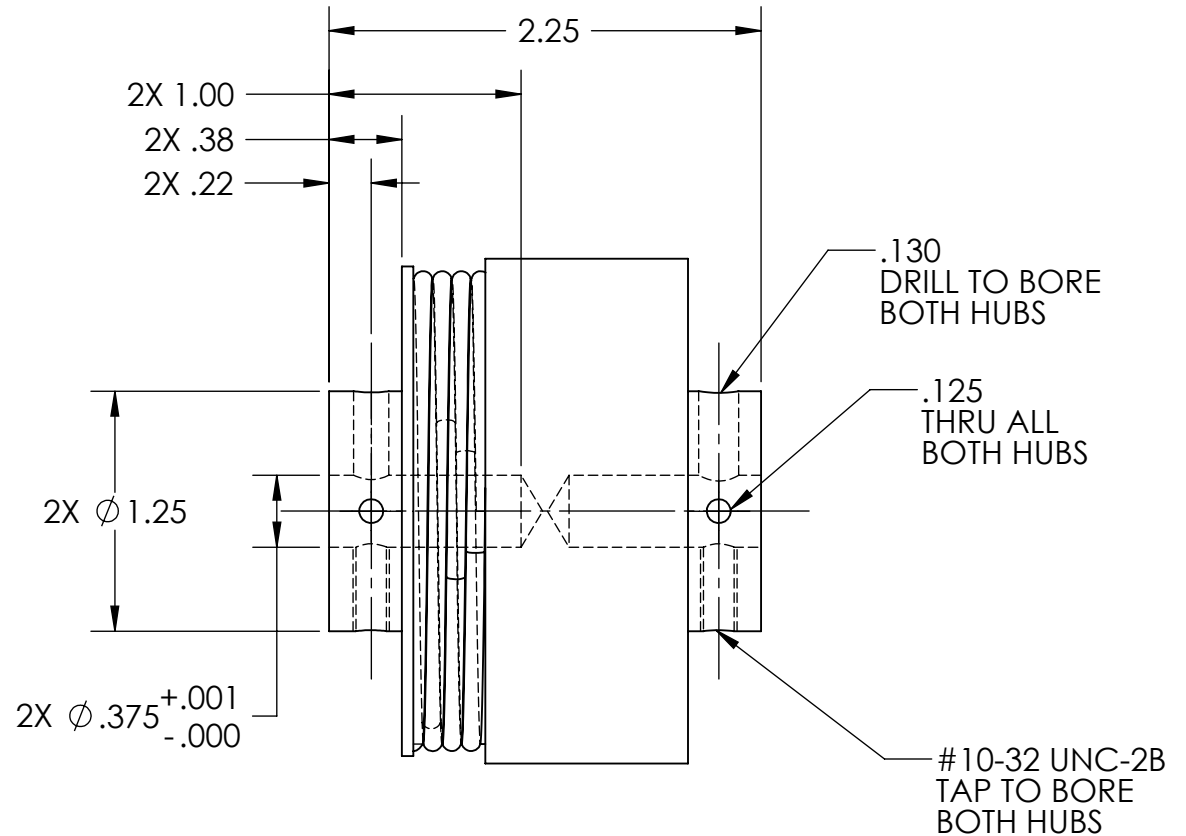
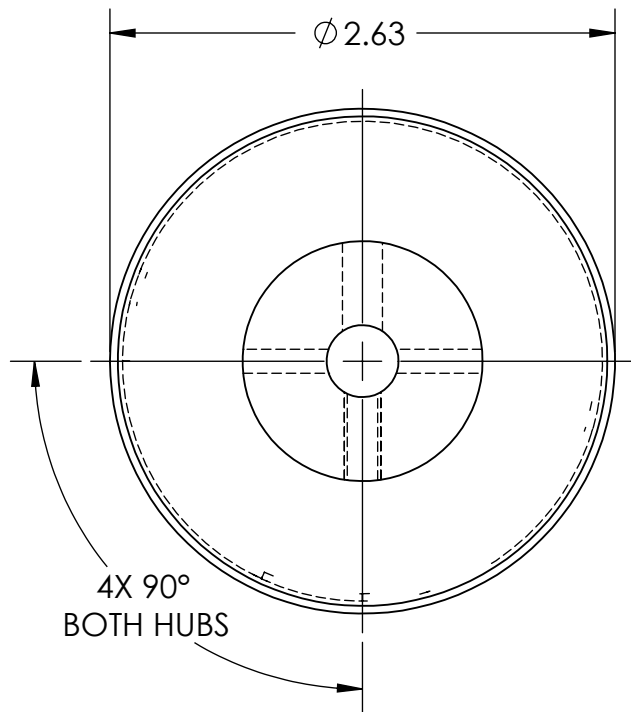

NOTE:

1. SET TORQUE TO 400IN-OZ \pm 40 IN-OZ
2. ASSEMBLE WITH TWO (2) SET SCREWS, BERG P/N SC2-55 18-8 STAINLESS STEEL 3/8" LONG

| TOLERANCES (EXCEPT AS NOTED) | | UNLESS OTHERWISE SPECIFIED | | BERG | | REXNORD INDUSTRIES, LLC | |
|------------------------------|--|-----------------------------|--|--------------|--|-------------------------|--|
| LINEAR | | SURFACE $\sqrt[3]{1.6}$ RMS | | FINISH | | www.rexnord.com | |
| .XX = $\pm .02$ | | REMOVE ALL BURRS | | TITL: | | SLIP COUPLING - SPECIAL | |
| .XXX = $\pm .005$ | | BREAK SHARP EDGES | | DWG# | | 041-136878106 | |
| [.X] = $\pm [.3]$ | | MAX. .005 RADIUS | | DRAWN BY: | | NLM 4/28/10 | |
| [.XX] = $\pm [.13]$ | | ON ALL EDGES & CORNERS | | CHECKED BY: | | LAN 4/28/10 | |
| ANGULAR | | DIMENSIONS IN INCHES | | MATERIAL: | | STAINLESS STEEL | |
| $\pm 0^\circ 30'$ | | DIMENSIONS IN [] | | TREATMENT | | OR FINISH | |
| FRACTIONS | | ARE IN MILLIMETERS | | APPROVED BY: | | NA NA | |
| $\pm 1/64$ | | ROUNDED BRACKETS SIGNIFY | | SIZE | | A | |
| 3RD ANGLE PROJECTION | | REFERENCE DIMENSIONS | | FSCM | | 29440 | |
| | | BERG DOCUMENT NUMBER | | SIMILAR TO: | | JJ-18 | |
| | | 4EO42-1B | | SCALE | | 1:1 | |
| | | | | SHT. | | 1 OF 1 | |
| | | | | REV. | | 6.4 | |